

GLENWOOD PARK

Atlanta, Georgia



TUNNELL-SPANGLER-WALSH & ASSOCIATES

CONGRESS FOR NEW URBANISM (CNU)
CHARTER AWARD 2003

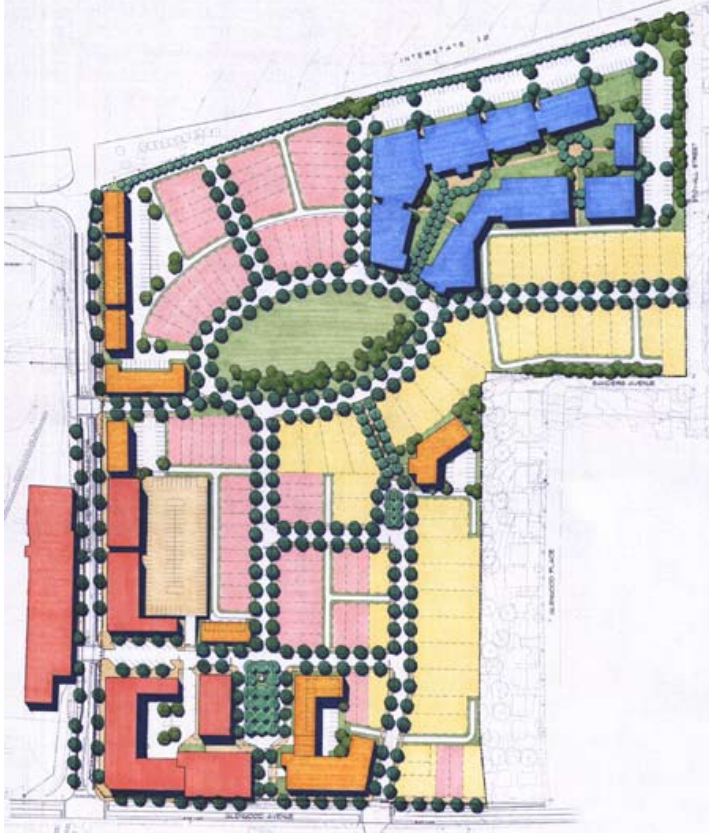

Glenwood Park, a development by Green Street Properties, is a new neighborhood based on new urbanism concepts. Located in East Atlanta, an area of the metro area offering affordable housing, Glenwood Park is one of many recent projects adding new energy to the existing community. The project, located on the old Blue Circle Concrete plant, reknits the urban fabric, tying together older residential areas and neighborhoods along Memorial Drive to the other side of I-20.

Within the development, one will find single-family homes, townhouses, flats over townhouses, multifamily units over retail and office space, and live/work units. All of the housing will be within a five-minute walk of retail, restaurants, and office space.

TSW began planning work on Glenwood Park during the conceptual phase and has continued to provide vision and direction for the development with updates of the master plan, zoning conditions, and by providing complete architectural services for the West Bartram Townhomes.

top left: Concept Master Plan for Glenwood Park

middle left: Mixed-use buildings fronting one of the many common areas (architecture by others)

bottom left: Single-family homes frame the streetscape (architecture by others)

below: West Bartram Townhomes



GLENWOOD PARK
Atlanta, Georgia



GLENWOOD PARK

Atlanta, Georgia



A variety of architectural types and styles are found at Glenwood Park (all architecture on this page is by others).

