

DYERSBURG STATE COMMUNITY COLLEGE

TSW was retained in 2002 by DSCC to update a master plan for the 110-acre main Dyersburg State Community College campus. The update incorporates changes that had occurred since the last plan (1991) and strongly supports the need for facility expansion while retaining the existing campus' scenic character. The plan was further revised when a significantly higher than expected student enrollment occurred in Fall 2003 and 2004.



Analysis chart for Dyersburg State Community College (TSW).



One of three concept plans for DSCC.



DSCC Master Plan

COLUMBIA STATE COMMUNITY COLLEGE and CLEVELAND STATE COMMUNITY COLLEGE

TSW used two models to analyze and communicate current and future space needs and utilization efficiencies for these two colleges, including the 1970's dated THEC (Tennessee Higher Education Commission) model, and the Georgia model developed by Thomas Walsh. The latter model incorporates more appropriate and accurate assumptions regarding space needs and use on today's campuses.

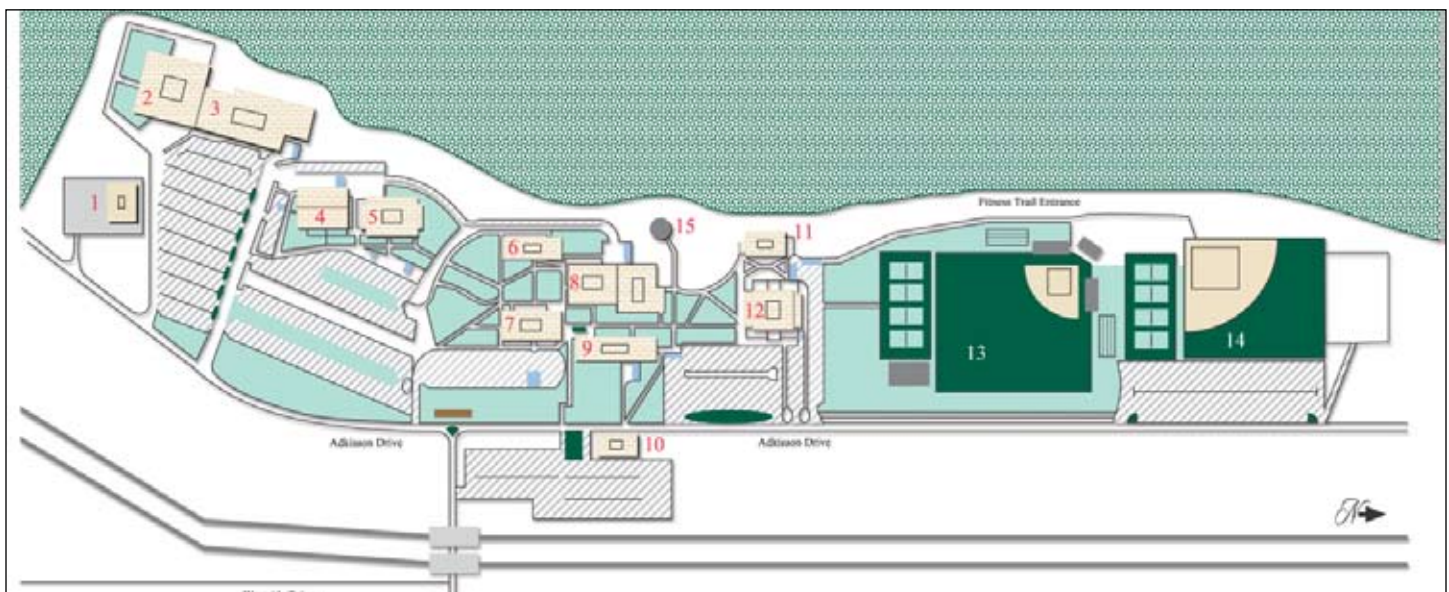

campus map courtesy of Cleveland State Community College